



**CONDUIT SYSTEMS
FOR ELECTRICAL WIRES
AND CABLES:**

ANACONDA FITTINGS

 **ANAMET EUROPE**
THE MANUFACTURER OF ANACONDA FITTINGS

Fitting selection table Anaconda / Anamet fittings.

Fitting	Material	Temperature (°C)		Thread size range			Shielding	Approvals			Protection	Page
		Min.	Max.	ISO	Pg	NPT		UL	CSA	GOST		
 Straight compact	Nickel plated brass	-45	+105	M16 to M63	Pg 11 to Pg 48	1/2" to 2"	+++	UL	CSA	PG GOST-R	IP 67	5-02
 90° compact	Nickel plated brass	-45	+105	M16 to M63	Pg 11 to Pg 48	1/2" to 2"	+++	UL	CSA	PG GOST-R	IP 67	5-02
 Swivel	Nickel plated brass	-45	+105	M16 to M63	-	1/2" to 1"	+++			PG GOST-R	IP 67	5-05
 Straight	Nickel plated brass	-45	+105	M12 to M105	Pg 7 to Pg 48	1/2" to 4"	+++	UL	CSA	PG GOST-R	IP 67	5-07
 Female	Nickel plated brass	-45	+105	M16 to M63	Pg 11 to Pg 48	1/2" to 2"	+++	RU C US		PG GOST-R	IP 67	5-08
 45°	Nickel plated brass	-45	+105	M16 to M63	Pg 11 to Pg 48	1/2" to 2"	+++	UL	CSA	PG GOST-R	IP 67	5-08
 90°	Nickel plated brass	-45	+105	M16 to M63	Pg 11 to Pg 48	1/2" to 2"	+++	UL	CSA	PG GOST-R	IP 67	5-08
 Cable-hose (EMC)	Nickel plated brass	-40	+100	M16 to M63	Pg 9 to Pg 29	1/2" to 3/4"	+++			PG GOST-R	IP 67	5-09
 Straight compact	Stainless-steel	-45	+105	M16 to M63	-	1/2" to 2"	+++	UL	CSA	PG GOST-R	IP 67	5-14
 Straight	Stainless-steel	-45	+105	M16 to M50	Pg 11 to Pg 48	1/2" to 1"	+++	UL	CSA	PG GOST-R	IP 67	5-16
 45°	Stainless-steel	-45	+105	M16 to M25	-	1/2" to 3/4"	+++	UL	CSA	PG GOST-R	IP 67	5-16
 90°	Stainless-steel	-45	+105	M16 to M25	Pg 11 to Pg 29	1/2" to 1"	+++	UL	CSA	PG GOST-R	IP 67	5-17
 Straight	Stainless-steel	-45	+105	M16 to M63	-	-	+++			PG GOST-R	IP 67	5-20
 Straight	Zinc die casted	-40	+125	M50 to M63	-	2.1/2" to 4"	+++				IP 67	5-23
 Straight	Galvanised steel	-55	+300	M16 to M32	Pg 11 to Pg 48	1/2" to 4"	+++	UL	CSA	PG GOST-R	IP 67	5-24
 90°	Galvanised steel	-55	+300	M16 to M32	Pg 11 to Pg 48	1/2" to 4"	+++	UL	CSA	PG GOST-R	IP 67	5-24

* Accessories are mentioned in chapter 6 (special fittings and accessories)



Anaconda compact fittings, UL & CSA, nickel plated brass, for Anaconda Sealtite.

The compact version nickel plated brass Anaconda fittings can be used with all types of Anaconda Sealtite (except CNP). This Anaconda fitting is a universal fitting with shorter design and lower weight. All ferrules are flanged versions for a better fit. The high quality nickel plating offers excellent corrosion protection in combination with a nice appearance. The compact fittings have UL & CSA approval.

Construction: Nickel plated brass fitting, consisting of 4 parts (counter nut, clamping ring, ferrule and body).

Material: Counter nut and body are nickel plated brass. Clamping ring is made from PA6 and the ferrule is made



from galvanised steel. The O-rings are from NBR rubber (black for ISO and blue for Pg).

Special approvals: UL-514B and CSA C 22.2 (combined UL/CSA file # E 234207).

Suitable for use in hazardous environments according NEC:

- Article 501.10 (B) (2) Class I, Division 2
- Article 502.10 (A) (2) and (B) (2) Class II, Division 1 and 2
- Article 503.10 (A) (3) and (B) Class III, Division 1 and 2

Temperature: -45 °C till +105 °C continuous

Protection class: IP 67 (dust-proof, water-tight)

Colour: Metal

ISO straight fitting, compact, male, nickel plated brass.

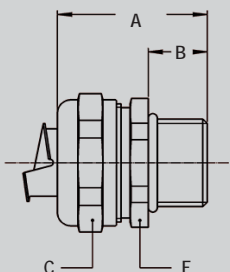

Thread	Sealtite Size (inch)	Min. Internal Bore (mm)	Dimensions in mm					Standard Package	Article Number	Weight (Kg/100)
			A	B	C	D	E			
M16 x 1,5	3/8"	11,0	31	10	26	-	24	10	712.016.1	3,9
M20 x 1,5	3/8"	11,0	31	10	26	-	24	10	712.017.1	4,0
M20 x 1,5	1/2"	14,5	32	10	29	-	27	10	712.020.1	4,4
M25 x 1,5	3/4"	19,4	33	10	35	-	33	5	712.025.1	6,6
M32 x 1,5	1"	24,7	36	12	45	-	42	5	712.032.1	11,7
M40 x 1,5	1.1/4"	33,3	40	13	53	-	50	2	712.040.1	16,0
M50 x 1,5	1.1/2"	38,0	46	14	62	-	58	2	712.050.1	25,3
M63 x 1,5	2"	49,0	52	16	76	-	72	2	712.063.1	38,6

ISO 90° fitting, compact, male, nickel plated brass.

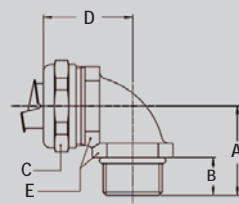

Thread	Sealtite Size (inch)	Min. Internal Bore (mm)	Dimensions in mm					Standard Package	Article Number	Weight (Kg/100)
			A	B	C	D	E			
M16 x 1,5	3/8"	11,0	26	10	26	31	22	10	712.916.1	6,6
M20 x 1,5	3/8"	11,0	26	10	26	32	24	10	712.917.1	7,9
M20 x 1,5	1/2"	14,5	28	10	29	34	27	10	712.920.1	9,2
M25 x 1,5	3/4"	19,4	32	10	35	40	33	5	712.925.1	16,2
M32 x 1,5	1"	24,7	40	12	45	49	42	5	712.932.1	27,8
M40 x 1,5	1.1/4"	33,3	46	13	53	53	52	2	712.940.1	40,1
M50 x 1,5	1.1/2"	38,0	52	14	62	57	60	2	712.950.1	57,5
M63 x 1,5	2"	49,0	62	16	76	68	72	2	712.963.1	90,6

Pg straight fitting, compact, male, nickel plated brass.

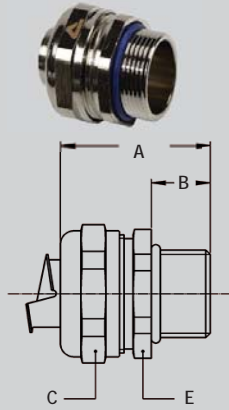

Thread	Sealtite Size (inch)	Min. Internal Bore (mm)	Dimensions in mm					Standard Package	Article Number	Weight (Kg/100)
			A	B	C	D	E			
Pg 11	3/8"	11,0	31	10	26	-	24	10	710.011.1	4,0
Pg 13,5	3/8"	11,0	31	10	26	-	24	10	710.013.1	4,2
Pg 16	1/2"	14,5	32	10	29	-	27	10	710.016.1	4,5
Pg 21	3/4"	19,4	33	10	35	-	33	5	710.021.1	6,5
Pg 29	1"	24,7	36	12	45	-	44	5	710.029.1	12,2
Pg 36	1.1/4"	33,3	40	13	53	-	52	2	710.036.1	16,4
Pg 42	1.1/2"	38,0	46	14	62	-	60	2	710.042.1	26,3
Pg 48	2"	49,0	52	16	76	-	72	2	710.048.1	38,6

Pg 90° fitting, compact, male, nickel plated brass.

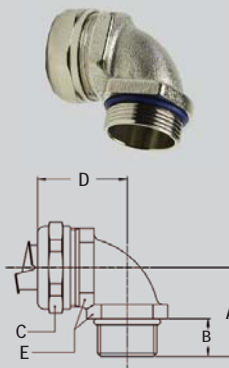

Thread	Sealtite Size (inch)	Min. Internal Bore (mm)	Dimensions in mm					Standard Package	Article Number	Weight (Kg/100)
			A	B	C	D	E			
Pg 11	3/8"	11,0	26	10	26	32	24	10	710.911.1	7,7
Pg 13,5	3/8"	11,0	26	10	26	32	24	10	710.913.1	8,0
Pg 16	1/2"	14,5	28	10	29	34	27	10	710.916.1	9,2
Pg 21	3/4"	19,4	32	10	35	40	33	5	710.921.1	15,7
Pg 29	1"	24,7	40	12	45	49	42	5	710.929.1	28,6
Pg 36	1.1/4"	33,3	46	13	53	53	52	2	710.936.1	40,1
Pg 42	1.1/2"	38,0	52	14	62	57	60	2	710.942.1	57,5
Pg 48	2"	49,0	62	16	76	68	72	2	710.948.1	92,1

NPT straight fitting, compact, male, nickel plated brass.

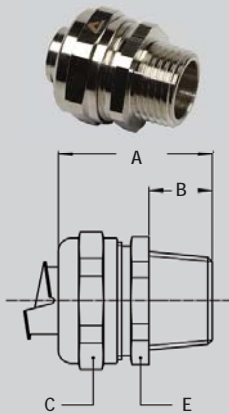

Thread	Sealtite Size (inch)	Min. Internal Bore (mm)	Dimensions in mm					Standard Package	Article Number	Weight (Kg/100)
			A	B	C	D	E			
NPT 1/2"	3/8"	11,0	35	14	26	-	24	10	714.012.1	4,4
NPT 1/2"	1/2"	14,5	36	14	29	-	27	10	714.016.1	5,0
NPT 3/4"	3/4"	19,4	37	14	35	-	33	5	714.020.1	7,0
NPT 1"	1"	24,7	40	16	45	-	42	5	714.026.1	12,6
NPT 1.1/4"	1.1/4"	33,3	43	16	53	-	50	2	714.035.1	16,8
NPT 1.1/2"	1.1/2"	38,0	50	18	62	-	58	2	714.040.1	25,8
NPT 2"	2"	49,0	56	20	76	-	72	2	714.050.1	41,2

NPT 90° fitting, compact, male, nickel plated brass.

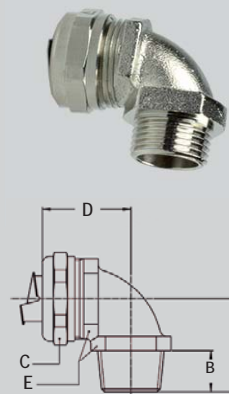

Thread	Sealtite Size (inch)	Min. Internal Bore (mm)	Dimensions in mm					Standard Package	Article Number	Weight (Kg/100)
			A	B	C	D	E			
NPT 1/2"	3/8"	11,0	30	14	26	32	24	10	714.912.1	8,2
NPT 1/2"	1/2"	14,5	32	14	29	34	27	10	714.916.1	9,6
NPT 3/4"	3/4"	19,4	36	14	35	40	33	5	714.920.1	16,7
NPT 1"	1"	24,7	44	16	45	49	42	5	714.926.1	28,3
NPT 1.1/4"	1.1/4"	33,3	49	16	53	53	52	2	714.935.1	41,4
NPT 1.1/2"	1.1/2"	38,0	56	18	62	57	60	2	714.940.1	57,3
NPT 2"	2"	49,0	66	20	76	68	72	2	714.950.1	90,8

ANACONDA
COMPACT
FITTINGS

LIQUID-TIGHT
FITTINGS FOR
SEALTITE
IP 67

NPT straight fitting, compact, male, nickel plated brass, including washer and locknut

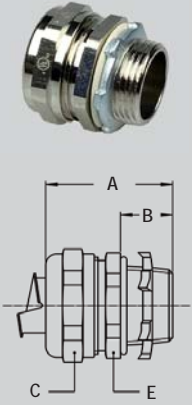

Thread	Sealtite Size (inch)	Min. Internal Bore (mm)	Dimensions in mm					Standard Package	Article Number	Weight (Kg/100)
			A	B	C	D	E			
NPT 1/2"	3/8"	11,0	35	14	26	-	24	10	714.012.2	4,9
NPT 1/2"	1/2"	14,5	36	14	29	-	27	10	714.016.2	5,5
NPT 3/4"	3/4"	19,4	37	14	35	-	33	5	714.020.2	7,8
NPT 1"	1"	24,7	40	16	45	-	42	5	714.026.2	13,9
NPT 1.1/4"	1.1/4"	33,3	43	16	53	-	50	2	714.035.2	18,6
NPT 1.1/2"	1.1/2"	38,0	50	18	62	-	58	2	714.040.2	28,0
NPT 2"	2"	49,0	56	20	76	-	72	2	714.050.2	44,0

NPT 90° fitting, compact, male, nickel plated brass, including washer and locknut

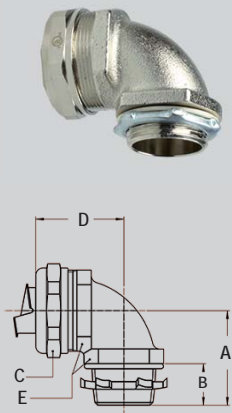

Thread	Sealtite Size (inch)	Min. Internal Bore (mm)	Dimensions in mm					Standard Package	Article Number	Weight (Kg/100)
			A	B	C	D	E			
NPT 1/2"	3/8"	11,0	30	14	26	32	24	10	714.912.2	8,7
NPT 1/2"	1/2"	14,5	32	14	29	34	27	10	714.916.2	10,1
NPT 3/4"	3/4"	19,4	36	14	35	40	33	5	714.920.2	16,6
NPT 1"	1"	24,7	44	16	45	49	42	5	714.926.2	29,6
NPT 1.1/4"	1.1/4"	33,3	49	16	53	53	52	2	714.935.2	43,2
NPT 1.1/2"	1.1/2"	38,0	56	18	62	57	60	2	714.940.2	59,5
NPT 2"	2"	49,0	66	20	76	68	72	2	714.950.2	93,6

Grounding ferrule, galvanised steel



Thread	Sealtite Size (inch)	Min. Internal Bore (mm)	Dimensions in mm					Standard Package	Article Number	Weight (Kg/100)
			A	B	C	D	E			
-	3/8"	11,0	-	-	-	-	-	50	815.011.2	0,4
-	1/2"	14,5	-	-	-	-	-	50	815.016.2	0,5
-	3/4"	19,4	-	-	-	-	-	25	815.021.2	0,7
-	1"	24,7	-	-	-	-	-	25	815.029.2	1,1
-	1.1/4"	33,3	-	-	-	-	-	10	815.036.2	1,5
-	1.1/2"	38,0	-	-	-	-	-	10	815.042.2	2,1
-	2"	49,0	-	-	-	-	-	10	815.048.2	3,2

NPT locknut, galvanised steel



Thread	Sealtite Size (inch)	Min. Internal Bore (mm)	Dimensions in mm					Standard Package	Article Number	Weight (Kg/100)
			A	B	C	D	E			
NPT 1/2"	1/2"	-	-	-	-	-	-	100	880.316.0	0,5
NPT 3/4"	3/4"	-	-	-	-	-	-	50	880.320.0	0,8
NPT 1"	1"	-	-	-	-	-	-	50	880.326.0	1,3
NPT 1.1/4"	1.1/4"	-	-	-	-	-	-	20	880.335.0	1,8
NPT 1.1/2"	1.1/2"	-	-	-	-	-	-	20	880.340.0	2,2
NPT 2"	2"	-	-	-	-	-	-	20	880.350.0	2,8

ANACONDA
COMPACT
FITTINGS

LIQUID-TIGHT
FITTINGS FOR
SEALTITE
IP 67



Anaconda swivel fittings, nickel plated brass, for Anaconda Sealtite.

The swivel version nickel plated brass Anaconda fittings can be used with all types of Anaconda Sealtite (except CNP). This Anaconda fitting is a universal fitting with a special swivel mechanism for a higher tensile strength and a high water proof protection (IP67). All ferrules are turned nickel plated brass versions for a better fit. The high quality nickel plating offers excellent corrosion protection in combination with a nice appearance.



Construction: Nickel plated brass fitting, consisting of 4 parts (counter nut, clamping ring, ferrule and body).

Material: Counter nut and body are nickel plated brass. Clamping ring is made from PA6 and the ferrule is made from nickel plated brass. The O-rings are from NBR rubber (black for ISO).

Temperature: -45 °C till +105 °C continuous

Protection class: IP 67

Colour: Metal

ANACONDA COMPACT FITTINGS

LIQUID-TIGHT FITTINGS FOR SEALTITE IP 67

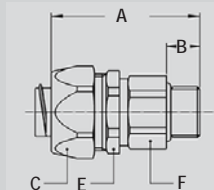

ISO straight swivel fitting, male, nickel plated brass

Thread	Sealtite Size (inch)	Min. Internal Bore (mm)	Dimensions in mm						Standard Package	Article Number	Weight (Kg/100)
			A	B	C	E	F				
M16 x 1,5	5/16"	8,3	48	10	26	24	21	10	813.015.0	8,1	
M16 x 1,5	3/8"	10,4	48	10	26	24	21	10	813.016.0	8,1	
M20 x 1,5	1/2"	13,8	49	10	29	27	25	10	813.020.0	10,2	
M25 x 1,5	3/4"	17,4	49	10	35	33	31	5	813.025.0	13,8	
M32 x 1,5	1"	23,4	55	12	45	42	38	5	813.032.0	32,5	
M40 x 1,5	1.1/4"	29,4	58	14	54	50	48	2	813.040.0	53,0	
M50 x 1,5	1.1/2"	36,9	65	14	62	58	55	2	813.050.0	74,0	
M63 x 1,5	2"	47,9	74	16	76	72	68	2	813.063.0	130,0	

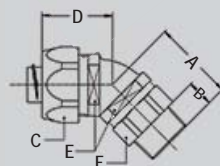

ISO 45° swivel fitting, male, nickel plated brass.

Thread	Sealtite Size (inch)	Min. Internal Bore (mm)	Dimensions in mm						Standard Package	Article Number	Weight (Kg/100)
			A	B	C	D	E	F			
M16 x 1,5	3/8"	10,4	34	10	26	28	22	21	10	813.416.0	9,5
M20 x 1,5	1/2"	13,8	34	10	29	30	27	25	10	813.420.0	13,5
M25 x 1,5	3/4"	17,4	37	10	35	32	33	31	5	813.425.0	21,5
M32 x 1,5	1"	23,4	41	12	45	37	42	38	5	813.432.0	36,5



ISO 90° swivel fitting, male, nickel plated brass

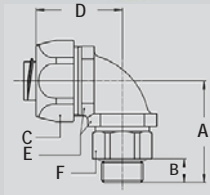

Thread	Sealtite Size (inch)	Min. Internal Bore (mm)	Dimensions in mm						Standard Package	Article Number	Weight (Kg/100)
			A	B	C	D	E	F			
M16 x 1,5	5/16"	8,3	39	10	26	35	22	21	10	813.915.0	10,8
M16 x 1,5	3/8"	10,4	39	10	26	35	22	21	10	813.916.0	10,8
M20 x 1,5	1/2"	13,8	39	10	29	37	27	25	10	813.920.0	13,2
M25 x 1,5	3/4"	17,4	46	10	35	44	33	31	5	813.925.0	22,8
M32 x 1,5	1"	23,4	55	12	45	55	42	38	5	813.932.0	41,4

NPT 45° swivel fitting, male, nickel plated brass

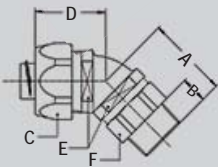

Thread	Sealtite Size (inch)	Min. Internal Bore (mm)	Dimensions in mm						Standard Package	Article Number	Weight (Kg/100)
			A	B	C	D	E	F			
NPT 1/2"	3/8"	10,4	36	12	26	28	22	22	10	819.412.0	11,5
NPT 1/2"	1/2"	13,8	36	12	29	30	27	25	10	819.416.0	14,0
NPT 3/4"	3/4"	17,4	39	12	35	32	33	31	5	819.420.0	22,0
NPT 1"	1"	23,4	42	13	45	37	42	38	5	819.426.0	37,0

NPT 90° swivel fitting, male, nickel plated brass

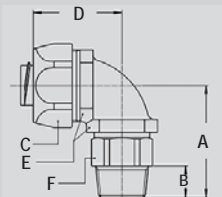

Thread	Sealtite Size (inch)	Min. Internal Bore (mm)	Dimensions in mm						Standard Package	Article Number	Weight (Kg/100)
			A	B	C	D	E	F			
NPT 1/2"	3/8"	10,4	41	12	26	35	22	22	10	819.912.0	12,0
NPT 1/2"	1/2"	13,8	41	12	29	37	27	25	10	819.916.0	14,0
NPT 3/4"	3/4"	17,4	48	12	35	44	33	31	5	819.920.0	23,5
NPT 1"	1"	23,4	56	13	45	55	42	38	5	819.926.0	42,0

ANACONDA
COMPACT
FITTINGS

LIQUID-TIGHT
FITTINGS FOR
SEALTITE
IP 67

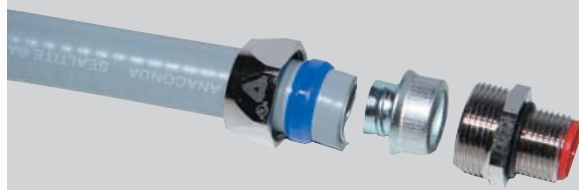

Anaconda nickel plated brass fittings for Anaconda Sealbite.

The nickel plated brass Anaconda fittings can be used with all types of Anaconda Sealbite (except CNP). This Anaconda fitting is the most used universal fitting and offers great corrosion protection in combination with a nice appearance. Because of the UL & CSA approvals the fittings are also suitable for export projects outside Europe.

Construction: Nickel plated brass fitting, consisting of 4 parts (counter nut, clamping ring, ferrule and body).

Material: Counter nut, body and ferrule are nickel plated brass with exception of size 3/8" till 1" where the ferrule is from galvanised steel. Clamping ring and inserts are made

from PA6 (red for ISO metric, blue for Pg and white for NPT). **Special approvals:** UL-514B and CSA C 22.2 (combined UL/CSA file # E 234207).

Suitable for use in hazardous environments according NEC:

- Article 501.10 (B) (2) Class I, Division 2
- Article 502.10 (A) (2) and (B) (2) Class II, Division 1 and 2
- Article 503.10 (A) (3) and (B) Class III, Division 1 and 2

Temperature: -45 °C till +105 °C continuous (cable-hose-fittings are -40 °C till +100 °C).

Protection class: IP 67 (dust-proof, water-tight), with cable-hose fittings an IP 68 rate on the switchbox can be obtained. Swivel fittings are limited to IP 65. **Colour:** Metal.

ANACONDA FITTINGS

LIQUID-TIGHT FITTINGS FOR SEALTITE IP 67



ISO straight fitting, male, nickel plated brass.

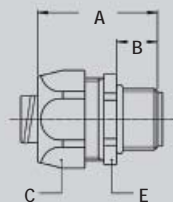

Thread	Sealbite Size (inch)	Min. Internal Bore (mm)	Dimensions in mm					Standard Package	Article Number	Weight (Kg/100)
			A	B	C	D	E			
M12 x 1,5	1/4"	5,2	33	10	22	-	20	10	812.012.1*	4,8
M16 x 1,5	5/16"	8,3	35	12	26	-	24	10	812.015.1*	4,8
M20 x 1,5	5/16"	8,3	36	13	26	-	24	10	812.014.1*	5,1
M16 x 1,5	3/8"	10,2	35	12	26	-	24	10	812.016.1	4,8
M20 x 1,5	3/8"	10,2	36	13	26	-	24	10	812.017.1	5,1
M20 x 1,5	1/2"	13,9	37	13	29	-	27	10	812.020.1	5,9
M25 x 1,5	3/4"	18,5	40	15	35	-	33	5	812.025.1	7,9
M32 x 1,5	1"	23,8	46	15	45	-	43	5	812.032.1	17,5
M40 x 1,5	1.1/4"	31,8	52	16	54	-	52	2	812.040.1	27,9
M50 x 1,5	1.1/2"	36,8	56	18	63	-	60	2	812.050.1	42,3
M63 x 1,5	2"	47,8	66	20	77	-	74	2	812.063.1	73,5
M75 x 1,5	2.1/2"	59,0	72	24	95	-	90	1	812.075.1*	134,4

* Fittings for 1/4", 5/16" and 2.1/2" conduit without UL/CSA approval.



ISO straight fitting, small design, male, nickel plated brass.

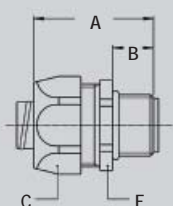

Thread	Sealbite Size (inch)	Min. Internal Bore (mm)	Dimensions in mm					Standard Package	Article Number	Weight (Kg/100)
			A	B	C	D	E			
M12 x 1,5	1/4"	5,2	33	10	19	-	17	10	812.012.2	2,8
M16 x 1,5	1/4"	5,2	35	12	19	-	19	10	812.013.2	3,4
M12 x 1,5	5/16"	8,3	33	10	22	-	20	10	812.011.2	3,6
M16 x 1,5	5/16"	8,3	35	12	22	-	20	10	812.015.2	3,8
M20 x 1,5	5/16"	8,3	36	13	22	-	24	10	812.014.2	4,2

ISO straight fitting, female, nickel plated brass.

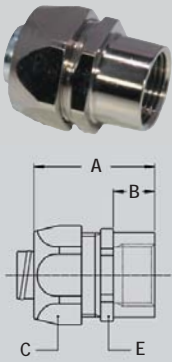

Thread	Seallite	Min. Internal Bore (mm)	Dimensions in mm					Standard Package	Article Number	Weight (Kg/100)
			A	B	C	D	E			
M16 x 1,5	5/16"	8,3	35	12	26	-	24	10	812.315.1*	5,0
M16 x 1,5	3/8"	10,2	35	12	26	-	24	10	812.316.1	5,0
M20 x 1,5	1/2"	13,9	37	13	29	-	27	10	812.320.1	7,6
M25 x 1,5	3/4"	18,5	40	15	35	-	33	5	812.325.1	9,0
M32 x 1,5	1"	23,8	46	15	45	-	43	5	812.332.1	18,3
M40 x 1,5	1.1/4"	31,8	52	16	54	-	52	2	812.340.1	29,3
M50 x 1,5	1.1/2"	36,8	56	18	63	-	60	2	812.350.1	41,2
M63 x 1,5	2"	47,8	66	20	77	-	74	2	812.363.1	71,8

* Fittings for 5/16" conduit without UL/CSA approval.

ISO 45° fitting, male, nickel plated brass.

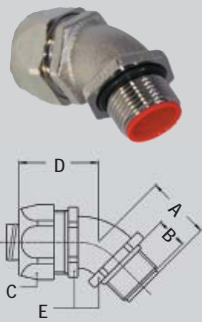

Thread	Seallite	Min. Internal Bore (mm)	Dimensions in mm					Standard Package	Article Number	Weight (Kg/100)
			A	B	C	D	E			
M16 x 1,5	5/16"	8,3	23	12	26	33	22	10	812.415.1*	7,3
M20 x 1,5	5/16"	8,3	24	13	26	33	22	10	812.414.1*	7,4
M16 x 1,5	3/8"	10,2	23	12	26	33	22	10	812.416.1	7,3
M20 x 1,5	3/8"	10,2	24	13	26	33	22	10	812.417.1	7,4
M20 x 1,5	1/2"	13,9	25	13	29	33	27	10	812.420.1	10,5
M25 x 1,5	3/4"	18,5	30	15	35	36	33	5	812.425.1	13,6
M32 x 1,5	1"	23,8	34	15	45	46	42	5	812.432.1	26,5
M40 x 1,5	1.1/4"	31,8	39	16	54	54	51	2	812.440.1	44,9
M50 x 1,5	1.1/2"	36,8	45	18	63	59	60	2	812.450.1	67,5
M63 x 1,5	2"	47,8	53	20	77	71	74	2	812.463.1	128,0

* Fittings for 5/16" conduit without UL/CSA approval.

ISO 90° fitting, male, nickel plated brass.

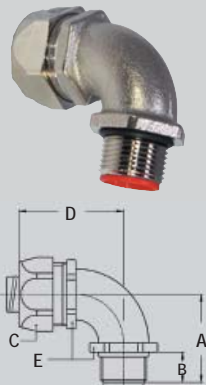

Thread	Seallite	Min. Internal Bore (mm)	Dimensions in mm					Standard Package	Article Number	Weight (Kg/100)
			A	B	C	D	E			
M16 x 1,5	5/16"	8,3	32	12	26	42	22	10	812.915.1*	8,2
M20 x 1,5	5/16"	8,3	33	13	26	42	22	10	812.914.1*	8,4
M16 x 1,5	3/8"	10,2	32	12	26	42	22	10	812.916.1	8,2
M20 x 1,5	3/8"	10,2	33	13	26	42	22	10	812.917.1	8,4
M20 x 1,5	1/2"	13,9	36	13	29	43	27	10	812.920.1	12,6
M25 x 1,5	3/4"	18,5	43	15	35	48	33	5	812.925.1	19,2
M32 x 1,5	1"	23,8	48	15	45	59	42	5	812.932.1	31,6
M40 x 1,5	1.1/4"	31,8	57	16	54	68	51	2	812.940.1	56,1
M50 x 1,5	1.1/2"	36,8	63	18	63	78	60	2	812.950.1	85,3
M63 x 1,5	2"	47,8	74	20	77	96	74	2	812.963.1	139,8

* Fittings for 5/16" conduit without UL/CSA approval.

ANACONDA
FITTINGS

LIQUID-TIGHT
FITTINGS FOR
SEALTITE
IP 67

ISO cable-hose fitting, male, nickel plated brass.

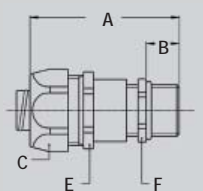

Thread ISO	Sealtite Size (inch)	Clamping Range (mm)	Dimensions in mm						Standard Package	Article Number	Weight (Kg/100)
			A	B	C	E	F				
M16 x 1,5	5/16"	4 - 8	57	12	26	24	18	10	812.715.2	5,2	
M16 x 1,5	3/8"	4 - 8	57	12	26	24	18	10	812.716.1	7,8	
M20 x 1,5	3/8"	6 - 10,2	57	12	26	24	22	10	812.717.1	9,5	
M20 x 1,5	1/2"	6 - 12	59	12	29	27	22	10	812.720.1	9,7	
M25 x 1,5	1/2"	10 - 13,9	62	12	29	27	27	10	812.722.1	11,7	
M32 x 1,5	3/4"	13 - 18	70	15	35	33	34	5	812.728.1	20,2	
M40 x 1,5	1"	18 - 23,5	83	15	45	43	43	2	812.735.1	32,6	
M40 x 1,5	1.1/4"	22 - 31,5	96	15	54	52	43	2	812.740.1	46,0	
M50 x 1,5	1.1/4"	22 - 31,8	96	15	54	52	55	2	812.745.1	60,0	

ISO, EMC cable-hose fitting, male, nickel plated brass.

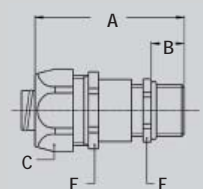
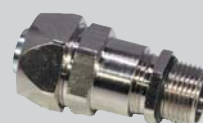

Thread ISO	Sealtite Size (inch)	Clamping Range (mm)	Dimensions in mm						Standard Package	Article Number	Weight (Kg/100)
			A	B	C	E	F				
M16 x 1,5	5/16"	4 - 8	57	12	26	24	18	10	812.615.2	5,2	
M16 x 1,5	3/8"	4 - 8	57	12	26	24	18	10	812.616.1	7,8	
M20 x 1,5	3/8"	6 - 10,2	57	12	26	24	22	10	812.617.1	9,5	
M20 x 1,5	1/2"	6 - 12	59	12	29	27	22	10	812.620.1	9,7	
M25 x 1,5	1/2"	10 - 13,9	62	12	29	27	27	5	812.622.1	11,7	
M32 x 1,5	3/4"	13 - 18	70	15	35	33	34	5	812.628.1	19,6	
M40 x 1,5	1"	18 - 23,8	83	15	45	43	43	2	812.635.1	35,4	

ISO cable-hose fitting, with extended clamping range, male, nickel plated brass.

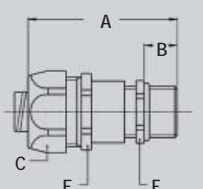

Thread ISO	Sealtite Size (inch)	Clamping Range (mm)	Dimensions in mm						Standard Package	Article Number	Weight (Kg/100)
			A	B	C	E	F				
M16 x 1,5	3/8"	3 - 10,2	64	12	26	24	20	10	812.716.2	8,2	
M20 x 1,5	1/2"	7 - 13,9	64	12	29	27	24	10	812.720.2	10,2	
M25 x 1,5	3/4"	9 - 18,0	77	15	35	33	30	5	812.725.2	17,0	
M32 x 1,5	1"	13 - 23,8	88	15	45	43	40	5	812.732.2	31,0	
M40 x 1,5	1.1/4"	20 - 31,8	102	15	54	52	50	2	812.740.2	54,6	
M50 x 1,5	1.1/2"	21 - 36,8	106	18	63	60	58	2	812.750.2	76,6	
M63 x 1,5	2"	27 - 44,0	116	18	77	74	68	2	812.763.2	116,6	

Multiple seals for cable hose fittings with extended range.



Thread ISO	Sealtite Size (inch)	number of holes x diam. (mm)	Dimensions in mm						Standard Package	Article Number	Weight (Kg/100)
			A	B	C	E	F				
M20 x 1,5	1/2"	3 x 4,0	-	-	-	-	-	100	785.234.0	-	
M20 x 1,5	1/2"	3 x 5,0	-	-	-	-	-	100	785.235.0	-	
M20 x 1,5	1/2"	4 x 3,0	-	-	-	-	-	100	785.243.0	-	
M20 x 1,5	1/2"	4 x 4,0	-	-	-	-	-	100	785.244.0	-	
M25 x 1,5	3/4"	2 x 7,0	-	-	-	-	-	100	785.327.0	-	
M25 x 1,5	3/4"	3 x 6,6	-	-	-	-	-	100	785.336.6	-	
M25 x 1,5	3/4"	3 x 8,0	-	-	-	-	-	100	785.338.0	-	
M32 x 1,5	1"	3 x 7,5	-	-	-	-	-	100	785.437.5	-	
M32 x 1,5	1"	4 x 8,0	-	-	-	-	-	100	785.448.0	-	
M32 x 1,5	1"	6 x 5,0	-	-	-	-	-	100	785.465.0	-	
M32 x 1,5	1"	6 x 6,0	-	-	-	-	-	100	785.466.0	-	

* Other (not mentioned types) are available on request. The multiple seals will be delivered separately.

**ANACONDA
FITTINGS**

**LIQUID-TIGHT
FITTINGS FOR
SEALTITE
IP 67**

Pg straight fitting, male, nickel plated brass.

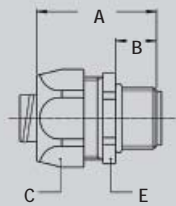

Thread	Sealtite Size (inch)	Min. Internal Bore (mm)	Dimensions in mm					Standard Package	Article Number	Weight (Kg/100)
			A	B	C	D	E			
Pg 7	1/4"	5,2	33	10	22	-	20	10	810.007.1*	3,0
Pg 9	5/16"	8,3	35	12	26	-	24	10	810.009.1*	4,8
Pg 11	5/16"	8,3	35	12	26	-	24	10	810.012.1*	5,6
Pg 13,5	5/16"	8,3	35	12	26	-	24	10	810.014.1*	5,6
Pg 9	3/8"	10,2	35	12	26	-	24	10	810.010.1	4,8
Pg 11	3/8"	10,2	35	12	26	-	24	10	810.011.1	5,6
Pg 13,5	3/8"	10,2	35	12	26	-	24	10	810.013.1	5,6
Pg 16	1/2"	13,9	37	13	29	-	27	10	810.016.1	6,3
Pg 21	3/4"	18,5	40	15	35	-	33	5	810.021.1	8,4
Pg 29	1"	23,8	46	15	45	-	43	5	810.029.1	25,0
Pg 36	1.1/4"	31,8	52	16	54	-	52	2	810.036.1	34,6
Pg 42	1.1/2"	36,8	56	18	63	-	60	2	810.042.1	47,2
Pg 48	2"	47,8	66	20	77	-	74	2	810.048.1	72,0

* Fittings for 1/4" and 5/16" conduit without UL/CSA approval.

Pg straight fitting, small design, male, nickel plated brass.

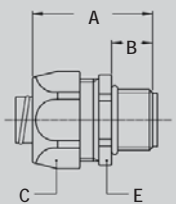

Thread	Sealtite Size (inch)	Min. Internal Bore (mm)	Dimensions in mm					Standard Package	Article Number	Weight (Kg/100)
			A	B	C	D	E			
Pg 7	1/4"	5,2	33	10	19	-	17	10	810.007.2	2,8
Pg 9	5/16"	8,3	35	12	22	-	20	10	810.009.2	3,8

Pg straight fitting, female, nickel plated brass.

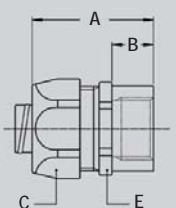

Thread	Sealtite Size (inch)	Min. Internal Bore (mm)	Dimensions in mm					Standard Package	Article Number	Weight (Kg/100)
			A	B	C	D	E			
Pg 11	5/16"	8,3	35	12	26	-	24	10	810.312.1*	5,3
Pg 13,5	5/16"	8,3	35	12	26	-	24	10	810.314.1*	5,3
Pg 11	3/8"	10,2	35	12	26	-	24	10	810.311.1	5,3
Pg 13,5	3/8"	10,2	35	12	26	-	24	10	810.313.1	5,3
Pg 16	1/2"	13,9	37	13	29	-	27	10	810.316.1	6,3
Pg 21	3/4"	18,5	40	15	35	-	33	5	810.321.1	9,3
Pg 29	1"	23,8	46	15	45	-	43	5	810.329.1	20,7
Pg 36	1.1/4"	31,8	52	16	54	-	52	2	810.336.1	29,3
Pg 42	1.1/2"	36,8	56	18	63	-	60	2	810.342.1	43,2
Pg 48	2"	47,8	66	20	77	-	74	2	810.348.1	74,8

* Fittings for 5/16" conduit without UL/CSA approval.

ANACONDA FITTINGS

LIQUID-TIGHT FITTINGS FOR SEALTITE IP 67

Pg 45° fitting, male, nickel plated brass.

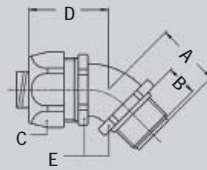

Thread	Sealtite Size (inch)	Min. Internal Bore (mm)	Dimensions in mm					Standard Package	Article Number	Weight (Kg/100)
			A	B	C	D	E			
Pg 11	5/16"	8,3	23	12	26	33	22	10	810.412.1*	8,1
Pg 13,5	5/16"	8,3	23	12	26	33	22	10	810.414.1*	8,1
Pg 11	3/8"	10,2	23	12	26	33	22	10	810.411.1	8,1
Pg 13,5	3/8"	10,2	23	12	26	33	22	10	810.413.1	8,1
Pg 16	1/2"	13,9	25	13	29	33	27	10	810.416.1	11,6
Pg 21	3/4"	18,5	30	15	35	36	33	5	810.421.1	15,3
Pg 29	1"	23,8	34	15	45	46	42	5	810.429.1	31,5
Pg 36	1.1/4"	31,8	39	16	54	54	51	2	810.436.1	53,2
Pg 42	1.1/2"	36,8	45	18	63	59	60	2	810.442.1	78,5
Pg 48	2"	47,8	53	20	77	71	74	2	810.448.1	132,0

* Fittings for 5/16" conduit without UL/CSA approval.

Pg 90° fitting, male, nickel plated brass.

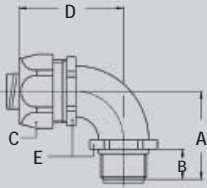

Thread	Sealtite Size (inch)	Min. Internal Bore (mm)	Dimensions in mm					Standard Package	Article Number	Weight (Kg/100)
			A	B	C	D	E			
Pg 11	5/16"	8,3	32	12	26	42	22	10	810.912.1*	8,9
Pg 13,5	5/16"	8,3	32	12	26	42	22	10	810.914.1*	8,9
Pg 11	3/8"	10,2	32	12	26	42	22	10	810.911.1	8,9
Pg 13,5	3/8"	10,2	32	12	26	42	22	10	810.913.1	8,9
Pg 16	1/2"	13,9	36	13	29	43	27	10	810.916.1	15,3
Pg 21	3/4"	18,5	43	15	35	48	33	5	810.921.1	21,6
Pg 29	1"	23,8	48	15	45	59	42	5	810.929.1	35,3
Pg 36	1.1/4"	31,8	57	16	54	68	51	2	810.936.1	62,5
Pg 42	1.1/2"	36,8	63	18	63	78	60	2	810.942.1	88,1
Pg 48	2"	47,8	74	20	77	96	74	2	810.948.1	141,9

* Fittings for 5/16" conduit without UL/CSA approval.

Pg cable-hose fitting, male, nickel plated brass.

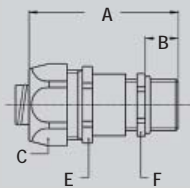

Thread	Sealtite Size (inch)	Clamping Range (mm)	Dimensions in mm					Standard Package	Article Number	Weight (Kg/100)
			A	B	C	E	F			
Pg 9	5/16"	4 - 8	55	10	26	24	17	10	810.709.1	7,8
Pg 9	3/8"	5 - 8	55	10	26	24	20	10	810.712.1	7,8
Pg 11	3/8"	5 - 10	55	10	26	24	20	10	810.711.1	9,5
Pg 13,5	1/2"	6 - 12	57	10	29	27	22	10	810.715.1	9,7
Pg 16	1/2"	10 - 13,9	60	10	29	27	24	10	810.716.1	11,7
Pg 21	3/4"	13 - 18	67	12	35	33	30	5	810.721.1	19,6
Pg 29	1"	18 - 23,8	80	12	45	43	40	5	810.729.1	35,4

Pg, EMC cable-hose fitting, male, nickel plated brass.

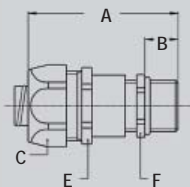

Thread	Sealtite Size (inch)	Clamping Range (mm)	Dimensions in mm					Standard Package	Article Number	Weight (Kg/100)
			A	B	C	E	F			
Pg 9	5/16"	4 - 8	55	10	26	24	17	10	810.609.1	7,8
Pg 9	3/8"	5 - 8	55	10	26	24	20	10	810.612.1	7,8
Pg 11	3/8"	5 - 10	55	10	26	24	20	10	810.611.1	9,5
Pg 13,5	1/2"	6 - 12	57	10	29	27	22	10	810.615.1	9,7
Pg 16	1/2"	10 - 13,9	60	10	29	27	24	10	810.616.1	11,7
Pg 21	3/4"	13 - 18	67	12	35	33	30	5	810.621.1	19,6
Pg 29	1"	18 - 23,8	80	12	45	43	40	5	810.629.1	35,4

ANACONDA FITTINGS

LIQUID-TIGHT FITTINGS FOR SEALTITE IP 67



NPT straight fitting, male, nickel plated brass.

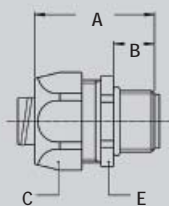

Thread	Sealtite Size (inch)	Min. Internal Bore (mm)	Dimensions in mm					Standard Package	Article Number	Weight (Kg/100)
			A	B	C	D	E			
1/2" NPT	5/16"	8,3	35	12	26	-	24	10	814.011.1*	5,6
1/2" NPT	3/8"	10,2	35	12	26	-	24	10	814.012.1	5,6
1/2" NPT	1/2"	13,9	37	13	29	-	27	10	814.016.1	6,2
3/4" NPT	3/4"	18,5	40	15	35	-	33	5	814.020.1	8,9
1" NPT	1"	23,8	46	15	45	-	43	5	814.026.1	25,0
1.1/4" NPT	1.1/4"	31,8	52	16	54	-	52	2	814.035.1	40,0
1.1/2" NPT	1.1/2"	36,8	56	18	63	-	60	2	814.040.1	43,8
2" NPT	2"	47,8	66	20	77	-	74	2	814.050.1	73,5

* Fittings for 1/4" and 5/16" conduit without UL/CSA approval.



NPT 45° fitting, male, nickel plated brass.

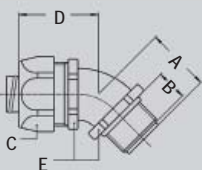

Thread	Sealtite Size (inch)	Min. Internal Bore (mm)	Dimensions in mm					Standard Package	Article Number	Weight (Kg/100)
			A	B	C	D	E			
1/2" NPT	5/16"	8,3	23	12	26	33	22	10	814.411.1*	7,9
1/2" NPT	3/8"	10,2	23	12	26	33	22	10	814.412.1	7,9
1/2" NPT	1/2"	13,9	25	13	29	33	27	10	814.416.1	10,7
3/4" NPT	3/4"	18,5	30	15	35	36	33	5	814.420.1	15,7
1" NPT	1"	23,8	34	15	45	46	42	5	814.426.1	31,8
1.1/4" NPT	1.1/4"	31,8	39	16	54	54	51	2	814.435.1	54,2
1.1/2" NPT	1.1/2"	36,8	45	18	63	59	60	2	814.440.1	78,5
2" NPT	2"	47,8	53	20	77	71	74	2	814.450.1	132,0

* Fittings for 5/16" conduit without UL/CSA approval.



NPT 90° fitting, male, nickel plated brass.

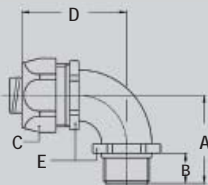

Thread	Sealtite Size (inch)	Min. Internal Bore (mm)	Dimensions in mm					Standard Package	Article Number	Weight (Kg/100)
			A	B	C	D	E			
1/2" NPT	5/16"	8,3	32	12	26	42	22	10	814.911.1*	13,3
1/2" NPT	3/8"	10,2	32	12	26	42	22	10	814.912.1	13,3
1/2" NPT	1/2"	13,9	36	13	29	43	27	10	814.916.1	14,6
3/4" NPT	3/4"	18,5	43	15	35	48	33	5	814.920.1	22,0
1" NPT	1"	23,8	48	15	45	59	42	5	814.926.1	31,7
1.1/4" NPT	1.1/4"	31,8	57	16	54	68	51	2	814.935.1	62,5
1.1/2" NPT	1.1/2"	36,8	63	18	63	78	60	2	814.940.1	89,1
2" NPT	2"	47,8	74	20	77	96	74	2	814.950.1	141,9

* Fittings for 5/16" conduit without UL/CSA approval.



NPT cable-hose fitting, male, nickel plated brass.

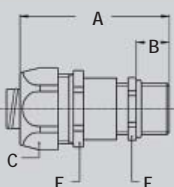

Thread	Sealtite Size (inch)	Clamping Range (mm)	Dimensions in mm					Standard Package	Article Number	Weight (Kg/100)
			A	B	C	E	F			
3/8" NPT	5/16"	4 - 8	60	15	26	24	17	10	814.709.1	7,8
3/8" NPT	3/8"	4 - 8	60	15	26	24	17	10	814.710.1	7,8
1/2" NPT	3/8"	6 - 10,2	57	13	26	24	22	10	814.712.1	11,7
1/2" NPT	1/2"	6 - 12	59	13	29	27	22	10	814.715.1	11,7
3/4" NPT	3/4"	13 - 18	68	13	35	33	30	5	814.721.1	19,6

NPT straight fitting, female, nickel plated brass.

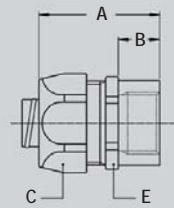

Thread	Sealtite Size (inch)	Min. Internal Bore (mm)	Dimensions in mm					Standard Package	Article Number	Weight (Kg/100)
			A	B	C	D	E			
1/2" NPT	5/16"	8,3	37	13	26	-	24	10	814.311.1*	5,3
1/2" NPT	3/8"	10,2	37	13	26	-	24	10	814.312.1	5,3
1/2" NPT	1/2"	13,9	37	13	29	-	27	10	814.316.1	6,2
3/4" NPT	3/4"	18,5	40	15	35	-	33	5	814.320.1	9,0
1" NPT	1"	23,8	46	15	45	-	43	5	814.326.1	20,7
1.1/4" NPT	1.1/4"	31,8	52	16	54	-	52	2	814.335.1	29,3
1.1/2" NPT	1.1/2"	36,8	56	18	63	-	60	2	814.340.1	43,8
2" NPT	2"	47,8	66	20	77	-	74	2	814.350.1	73,3

* Fittings for 5/16" conduit without UL/CSA approval.

Grounding ferrule, nickel plated brass.



Thread	Sealtite Size (inch)	Min. Internal Bore (mm)	Dimensions in mm					Standard Package	Article Number	Weight (Kg/100)
			A	B	C	D	E			
-	1/4"	5,2	-	-	-	-	-	10	815.006.0	0,4
-	5/16"	8,3	-	-	-	-	-	10	815.010.0	0,8
-	3/8"	10,2	-	-	-	-	-	10	815.011.3	0,6
-	1/2"	13,9	-	-	-	-	-	10	815.016.3	0,8
-	3/4"	18,5	-	-	-	-	-	5	815.021.3	1,4
-	1"	23,8	-	-	-	-	-	5	815.029.3	2,8
-	1.1/4"	31,8	-	-	-	-	-	2	815.036.3	6,0
-	1.1/2"	36,8	-	-	-	-	-	2	815.042.3	6,8
-	2"	47,8	-	-	-	-	-	2	815.048.3	8,8

Grounding ferrule, zinc plated steel.



Thread	Sealtite Size (inch)	Min. Internal Bore (mm)	Dimensions in mm					Standard Package	Article Number	Weight (Kg/100)
			A	B	C	D	E			
-	3/8"	10,2	-	-	-	-	-	10	815.011.0	0,4
-	1/2"	13,9	-	-	-	-	-	10	815.016.0	0,6
-	3/4"	18,5	-	-	-	-	-	5	815.021.0	0,8
-	1"	23,8	-	-	-	-	-	5	815.029.0	1,4

Neoprene Sealing gasket for ISO



Thread ISO	Thread Pg	Thread NPT	Dimensions in mm					Standard Package	Article Number	Weight (Kg/100)
			A	B	C	D	E			
M16 x 1,5	-	-	1,2	-	20	14	-	100	815.416.0	0,03
M20 x 1,5	-	-	1,2	-	24	18	-	100	815.420.0	0,03
M25 x 1,5	-	-	1,2	-	30	23	-	50	815.425.0	0,05
M32 x 1,5	-	-	1,2	-	40	30	-	50	815.432.0	0,11
M40 x 1,5	-	-	1,2	-	48	38	-	50	815.440.0	0,15
M50 x 1,5	-	-	1,2	-	58	48	-	50	815.450.0	0,19
M63 x 1,5	-	-	1,2	-	75	61	-	50	815.463.0	0,33

ANACONDA
FITTINGS

ACCESSORIES



Anaconda compact fittings, UL & CSA, stainless steel AISI-304, for Anaconda Sealtite.

The compact version stainless steel Anaconda fittings can be used with all types of Anaconda Sealtite (except CNP). This Anaconda fitting is a universal fitting with shorter design and lower weight. All ferrules are flanged versions for a better fit. Because the fitting and ferrule are made from Stainless steel AISI-304 they offer an excellent corrosion protection in combination with a nice appearance. The compact fittings have UL & CSA approval.

Construction: Stainless steel AISI-304, consisting of 4 parts (counter nut, clamping ring, ferrule and body).

Material: Counter nut, body and ferrule are stainless steel



AISI-304. Clamping ring is made from PA6. The O-rings are from NBR rubber (black for ISO and blue for Pg).

Special approvals: UL-514B and CSA C 22.2 (combined UL/CSA file # E 234207).

Suitable for use in hazardous environments according NEC:

- Article 501.10 (B) (2) Class I, Division 2
- Article 502.10 (A) (2) and (B) (2) Class II, Division 1 and 2
- Article 503.10 (A) (3) and (B) Class III, Division 1 and 2

Temperature: -45 °C till +105 °C continuous

Protection class: IP 67 (dust-proof, water-tight)

Colour: Metal

ISO straight fitting, compact, stainless steel AISI-304

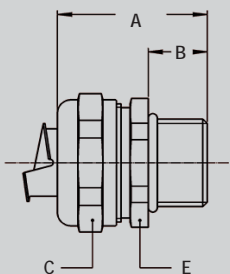

Thread	Sealtite Size (inch)	Min. Internal Bore (mm)	Dimensions in mm					Standard Package	Article Number	Weight (Kg/100)
			A	B	C	D	E			
M16 x 1,5	3/8"	11,0	31	10	26	-	24	10	712.016.9	3,9
M20 x 1,5	3/8"	11,0	31	10	26	-	24	10	712.017.9	4,0
M20 x 1,5	1/2"	14,5	32	10	29	-	27	10	712.020.9	4,4
M25 x 1,5	3/4"	19,4	33	10	35	-	33	5	712.025.9	6,6
M32 x 1,5	1"	24,7	36	12	45	-	42	5	712.032.9	11,7
M40 x 1,5	1.1/4"	33,3	40	13	53	-	50	2	712.040.9	16,0
M50 x 1,5	1.1/2"	38,0	46	14	62	-	58	2	712.050.9	25,3
M63 x 1,5	2"	49,0	52	16	76	-	72	2	712.063.9	38,6

NPT straight fitting, compact, male, stainless steel AISI-304

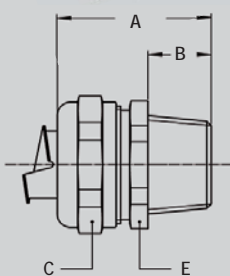

Thread	Sealtite Size (inch)	Min. Internal Bore (mm)	Dimensions in mm					Standard Package	Article Number	Weight (Kg/100)
			A	B	C	D	E			
NPT 1/2"	3/8"	11,0	35	14	26	-	24	10	714.012.9	4,4
NPT 1/2"	1/2"	14,5	36	14	29	-	27	10	714.016.9	5,0
NPT 3/4"	3/4"	19,4	37	14	35	-	33	5	714.020.9	7,0
NPT 1"	1"	24,7	40	16	45	-	42	5	714.026.9	12,6
NPT 1.1/4"	1.1/4"	33,3	43	16	53	-	50	2	714.035.9	16,8
NPT 1.1/2"	1.1/2"	38,0	50	18	62	-	58	2	714.040.9	25,8
NPT 2"	2"	49,0	56	20	76	-	72	2	714.050.9	41,2

NPT straight fitting, compact, male, stainless steel AISI-304, including washer and locknut

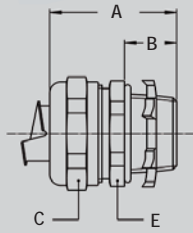

Thread NPT	Sealtite Size (inch)	Min. Internal Bore (mm)	Dimensions in mm					Standard Package	Article Number	Weight (Kg/100)
			A	B	C	D	E			
NPT 1/2"	3/8"	11,0	35	14	26	-	24	10	714.012.92	4,9
NPT 1/2"	1/2"	14,5	36	14	29	-	27	10	714.016.92	5,5
NPT 3/4"	3/4"	19,4	37	14	35	-	33	5	714.020.92	7,8
NPT 1"	1"	24,7	40	16	45	-	42	5	714.026.92	13,9
NPT 1.1/4"	1.1/4"	33,3	43	16	53	-	50	2	714.035.92	18,6
NPT 1.1/2"	1.1/2"	38,0	50	18	62	-	58	2	714.040.92	28,0
NPT 2"	2"	49,0	56	20	76	-	72	2	714.050.92	44,0

Grounding ferrule, stainless steel AISI-304



Thread	Sealtite Size (inch)	Min. Internal Bore (mm)	Dimensions in mm					Standard Package	Article Number	Weight (Kg/100)
			A	B	C	D	E			
-	3/8"	11,0	-	-	-	-	-	50	815.011.5	0,4
-	1/2"	14,5	-	-	-	-	-	50	815.016.5	0,5
-	3/4"	19,4	-	-	-	-	-	25	815.021.5	0,7
-	1"	24,7	-	-	-	-	-	25	815.029.5	1,1
-	1.1/4"	33,3	-	-	-	-	-	10	815.036.5	1,5
-	1.1/2"	38,0	-	-	-	-	-	10	815.042.5	2,1
-	2"	49,0	-	-	-	-	-	10	815.048.5	3,2

NPT locknut, stainless steel AISI-304



Thread	Sealtite Size (inch)	Min. Internal Bore (mm)	Dimensions in mm					Standard Package	Article Number	Weight (Kg/100)
			A	B	C	D	E			
NPT 1/2"	1/2"	-	-	-	-	-	-	100	880.316.9	0,5
NPT 3/4"	3/4"	-	-	-	-	-	-	50	880.320.9	0,8
NPT 1"	1"	-	-	-	-	-	-	50	880.326.9	1,3
NPT 1.1/4"	1.1/4"	-	-	-	-	-	-	20	880.335.9	1,8
NPT 1.1/2"	1.1/2"	-	-	-	-	-	-	20	880.340.9	2,2
NPT 2"	2"	-	-	-	-	-	-	20	880.350.9	2,8

NPT flat seal, NBR Rubber



Thread	Sealtite Size (inch)	Min. Internal Bore (mm)	Dimensions in mm					Standard Package	Article Number	Weight (Kg/100)
			A	B	C	D	E			
NPT 1/2"	1/2"	-	-	-	-	-	-	50	815.616.0	0,03
NPT 3/4"	3/4"	-	-	-	-	-	-	25	815.620.0	0,05
NPT 1"	1"	-	-	-	-	-	-	25	815.626.0	0,11
NPT 1.1/4"	1.1/4"	-	-	-	-	-	-	10	815.635.0	0,15
NPT 1.1/2"	1.1/2"	-	-	-	-	-	-	10	815.640.0	0,19
NPT 2"	2"	-	-	-	-	-	-	10	815.650.0	0,33

ANACONDA
COMPACT
FITTINGS

LIQUID-TIGHT
FITTINGS FOR
SEALTITE
IP 67

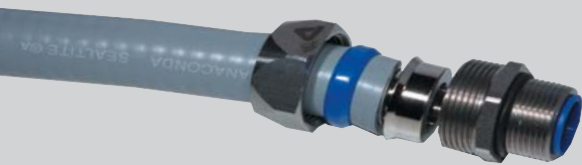

Anaconda stainless steel fittings for Anaconda Sealtite.

The stainless steel Anaconda fittings can be used with all types of Anaconda Sealtite (except CNP). These fittings are available in AISI-304 and AISI-316 and offer superior corrosion resistance. These stainless steel Anaconda fittings are mostly used in the off-shore, chemical and food industry. Because of the UL & CSA approvals the fittings are also suitable for export projects outside Europe.

Material & Construction:

Construction: Stainless steel (AISI-304) fitting, consisting of 4 parts (counter nut, clamping ring, ferrule and body).

Material: Counter nut and body are stainless steel (AISI-304) and the ferrule is from nickel plated brass. Clamping

ring and insert are from PA6 (red for ISO metric, blue for Pg and white for NPT).

Special approvals: UL-514B and CSA C 22.2 (combined UL/CSA file # E 234207).

Suitable for use in hazardous environments according NEC:

- Article 501.10 (B) (2) Class I, Division 2

- Article 502.10 (A) (2) and (B) (2) Class II, Division 1 and 2

- Article 503.10 (A) (3) and (B) Class III, Division 1 and 2

Temperature: -45 °C till +105 °C continuous (cable-hose fittings are -40 °C till +100 °C).

Protection class: IP 67 (dust-proof, water-tight), with cable-hose fittings an IP 68 rate on the switchbox can be obtained.

Colour: Metal.

ISO straight fitting, male, stainless steel (AISI-304).

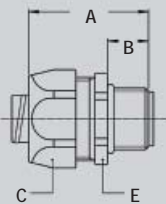

Thread	Sealtite	Min. Internal Bore (mm)	Dimensions in mm					Standard Package	Article Number	Weight (Kg/100)
			A	B	C	D	E			
M16 x 1,5	5/16"	8,3	35	12	27	-	24	10	812.015.9*	4,8
M20 x 1,5	5/16"	8,3	36	13	27	-	24	10	812.014.9*	5,1
M16 x 1,5	3/8"	10,2	35	12	27	-	24	10	812.016.9	4,8
M20 x 1,5	3/8"	10,2	36	13	27	-	24	10	812.017.9	5,1
M20 x 1,5	1/2"	13,9	37	13	30	-	27	10	812.020.9	5,9
M25 x 1,5	3/4"	18,5	40	15	36	-	36	5	812.025.9	7,9
M32 x 1,5	1"	23,8	46	15	46	-	46	5	812.032.9	17,5
M40 x 1,5	1.1/4"	31,8	52	16	54	-	52	2	812.040.9	27,9

* Fittings for 5/16" conduit without UL/CSA approval

ISO 45° fitting, male, stainless steel (AISI-304).

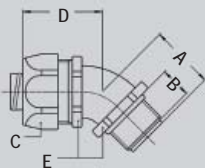

Thread	Sealtite	Min. Internal Bore (mm)	Dimensions in mm					Standard Package	Article Number	Weight (Kg/100)
			A	B	C	D	E			
M16 x 1,5	5/16"	8,3	23	12	27	33	22	10	812.415.9*	7,3
M20 x 1,5	5/16"	8,3	24	13	27	33	22	10	812.414.9*	7,4
M16 x 1,5	3/8"	10,2	23	12	27	33	22	10	812.416.9	7,3
M20 x 1,5	3/8"	10,2	24	13	27	33	22	10	812.417.9	7,4
M20 x 1,5	1/2"	13,9	25	13	30	33	27	10	812.420.9	10,5
M25 x 1,5	3/4"	18,5	30	15	36	36	33	5	812.425.9	13,6

* Fittings for 5/16" conduit without UL/CSA approval.

**ANACONDA
SEALTITE®
SPECIAL**

**LIQUID-TIGHT
FITTINGS FOR
SEALTITE
IP 67**

ISO 90° fitting, male, stainless steel (AISI-304).

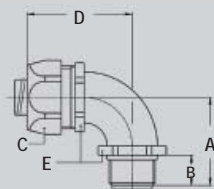

Thread	Sealtite Size (inch)	Min. Internal Bore (mm)	Dimensions in mm					Standard Package	Article Number	Weight (Kg/100)
			A	B	C	D	E			
M16 x 1,5	5/16"	8,3	32	12	27	42	22	10	812.915.9*	8,2
M20 x 1,5	5/16"	8,3	33	13	27	42	22	10	812.914.9*	8,4
M16 x 1,5	3/8"	10,2	32	12	27	42	22	10	812.916.9	8,2
M20 x 1,5	3/8"	10,2	33	13	27	42	22	10	812.917.9	8,4
M20 x 1,5	1/2"	13,9	36	13	30	43	27	10	812.920.9	12,6
M25 x 1,5	3/4"	18,5	43	15	36	48	33	5	812.925.9	19,2

* Fittings for 5/16" conduit without UL/CSA approval.

ISO cable-hose fitting, male, stainless steel (AISI-304).

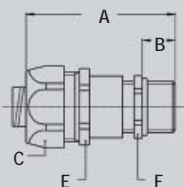

Thread	Sealtite Size (inch)	Clamping Range (mm)	Dimensions in mm					Standard Package	Article Number	Weight (Kg/100)
			A	B	C	E	F			
M16 x 1,5	5/16"	4 - 8	57	12	27	24	18	10	812.715.9*	7,8
M16 x 1,5	3/8"	4 - 8	57	12	27	24	18	10	812.716.9	7,8
M20 x 1,5	3/8"	6 - 10,2	57	12	27	24	22	10	812.717.9	9,5
M20 x 1,5	1/2"	6 - 12	59	12	30	27	22	10	812.720.9	9,7

* Fittings for 5/16" conduit.

Pg straight fitting, male, stainless steel (AISI-304).

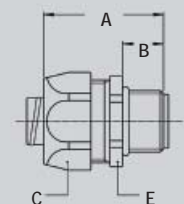

Thread	Sealtite Size (inch)	Min. Internal Bore (mm)	Dimensions in mm					Standard Package	Article Number	Weight (Kg/100)
			A	B	C	D	E			
Pg 11	5/16"	8,3	35	12	27	-	24	10	810.012.9*	5,6
Pg 13,5	5/16"	8,3	35	12	27	-	24	10	810.014.9*	5,6
Pg 11	3/8"	10,2	35	12	27	-	24	10	810.011.9	5,6
Pg 13,5	3/8"	10,2	35	12	27	-	24	10	810.013.9	5,6
Pg 16	1/2"	13,9	37	13	30	-	27	10	810.016.9	6,3
Pg 21	3/4"	18,5	40	15	36	-	36	5	810.021.9	8,4
Pg 29	1"	23,8	46	15	46	-	46	5	810.029.9	25,0
Pg 36	1.1/4"	31,8	52	16	54	-	52	2	810.036.9	34,6
Pg 42	1.1/2"	36,8	56	18	63	-	60	2	810.042.9	47,2
Pg 48	2"	47,8	66	20	77	-	74	2	810.048.9	72,0

* Fittings for 5/16" conduit without UL/CSA approval.

Pg 90° fitting, male, stainless steel (AISI-304).

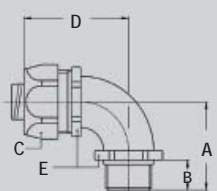

Thread	Sealtite Size (inch)	Min. Internal Bore (mm)	Dimensions in mm					Standard Package	Article Number	Weight (Kg/100)
			A	B	C	D	E			
Pg 11	5/16"	8,3	32	12	27	42	22	10	810.912.9*	8,9
Pg 11	3/8"	10,2	32	12	27	42	22	10	810.911.9	8,9
Pg 16	1/2"	13,9	36	13	30	43	27	10	810.916.9	15,3
Pg 21	3/4"	18,5	43	15	36	48	33	5	810.921.9	21,6
Pg 29	1"	23,8	48	15	46	50	42	5	810.929.9	35,3

* Fittings for 5/16" conduit without UL/CSA approval.

ANACONDA
SEALTITE®
SPECIAL

LIQUID-TIGHT
FITTINGS FOR
SEALTITE
IP 67

NPT straight fitting, male, stainless steel (AISI-304).

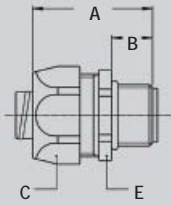

Thread	Sealtite Size (inch)	Min. Internal Bore (mm)	Dimensions in mm					Standard Package	Article Number	Weight (Kg/100)
			A	B	C	D	E			
1/2" NPT	5/16"	8,3	37	13	27	-	24	10	814.011.9*	5,6
1/2" NPT	3/8"	10,2	37	13	27	-	24	10	814.012.9	5,6
1/2" NPT	1/2"	13,9	37	13	30	-	27	10	814.016.9	6,2
3/4" NPT	3/4"	18,5	40	15	36	-	36	5	814.020.9	8,9
1" NPT	1"	23,8	46	15	46	-	46	5	814.026.9	25,0

* Fittings for 5/16" conduit without UL/CSA approval.

NPT 45° fitting, male, stainless steel (AISI-304).

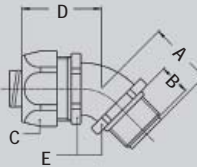

Thread	Sealtite Size (inch)	Min. Internal Bore (mm)	Dimensions in mm					Standard Package	Article Number	Weight (Kg/100)
			A	B	C	D	E			
1/2" NPT	5/16"	8,3	25	13	27	33	22	10	814.411.9*	7,9
1/2" NPT	3/8"	10,2	25	13	27	33	22	10	814.412.9	7,9
1/2" NPT	1/2"	13,9	25	13	30	33	27	10	814.416.9	10,7
3/4" NPT	3/4"	18,5	30	15	36	36	33	5	814.420.9	15,7

* Fittings for 5/16" conduit without UL/CSA approval.

NPT 90° fitting, male, stainless steel (AISI-304).

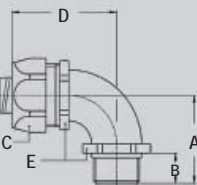

Thread	Sealtite Size (inch)	Min. Internal Bore (mm)	Dimensions in mm					Standard Package	Article Number	Weight (Kg/100)
			A	B	C	D	E			
1/2" NPT	5/16"	8,3	36	13	27	43	22	10	814.911.9*	13,3
1/2" NPT	3/8"	10,2	36	13	27	43	22	10	814.912.9	13,3
1/2" NPT	1/2"	13,9	36	13	30	43	27	10	814.916.9	14,6
3/4" NPT	3/4"	18,5	43	15	36	48	33	5	814.920.9	22,0
1" NPT	1"	23,8	48	15	46	59	42	5	814.926.9	31,7

* Fittings for 5/16" conduit without UL/CSA approval.

Grounding ferrule, nickel plated brass.



Thread	Sealtite Size (inch)	Min. Internal Bore (mm)	Dimensions in mm					Standard Package	Article Number	Weight (Kg/100)
			A	B	C	D	E			
-	5/16"	8,3	-	-	-	-	-	10	815.010.0	0,8
-	3/8"	10,2	-	-	-	-	-	10	815.011.3	0,6
-	1/2"	13,9	-	-	-	-	-	10	815.016.3	0,8
-	3/4"	18,5	-	-	-	-	-	5	815.021.3	1,4
-	1"	23,8	-	-	-	-	-	5	815.029.3	2,8
-	1.1/4"	31,8	-	-	-	-	-	2	815.036.3	6,0
-	1.1/2"	36,8	-	-	-	-	-	2	815.042.3	6,8
-	2"	47,8	-	-	-	-	-	2	815.048.3	8,8

ANACONDA
SEALTITE®
SPECIAL

LIQUID-TIGHT
FITTINGS FOR
SEALTITE
IP 67



Anaconda stainless steel AISI-316 fittings for Anaconda Sealtite.

The stainless steel AISI-316 Anaconda fittings can be used with all types of Anaconda Sealtite (except CNP) and offer the highest corrosion resistance. These stainless steel Anaconda fittings are mostly used in the off-shore, chemical and food industry. Because of the UL & CSA approvals the fittings are also suitable for export projects outside Europe.

Material & Construction:

Construction: Stainless steel (AISI-316) fitting, consisting of 4 parts (counter nut, clamping ring, ferrule and body).

Material: Counter nut and body are stainless steel (AISI-316) and the ferrule is from nickel plated brass. Clamping

ring and insert are from PA6 (red for ISO metric and white for NPT).

Special approvals: UL-514B and CSA C 22.2 (combined UL/CSA file # E 234207).

Suitable for use in hazardous environments according NEC:

- Article 501.10 (B) (2) Class I, Division 2
- Article 502.10 (A) (2) and (B) (2) Class II, Division 1 and 2
- Article 503.10 (A) (3) and (B) Class III, Division 1 and 2

Temperature: -45 °C till +105 °C continuous.

Protection class: IP 67 (dust-proof, water-tight).

Colour: Metal.

**ANACONDA
SEALTITE®
SPECIAL**

**LIQUID-TIGHT
FITTINGS FOR
SEALTITE
IP 67**

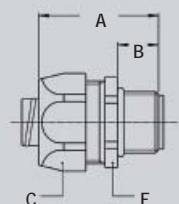

ISO straight fitting, male, stainless steel (AISI-316).



Thread	Sealtite Size (inch)	Min. Internal Bore (mm)	Dimensions in mm					Standard Package	Article Number	Weight (Kg/100)
			A	B	C	D	E			
M16 x 1,5	3/8"	10,2	35	12	26	-	24	10	812.116.9	4,8
M20 x 1,5	1/2"	13,9	37	13	29	-	27	10	812.120.9	5,9
M25 x 1,5	3/4"	18,5	40	15	35	-	33	5	812.125.9	7,9
M32 x 1,5	1"	23,8	46	15	45	-	43	5	812.132.9	17,5

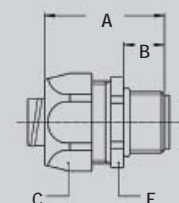

Pg straight fitting, male, stainless steel (AISI-316).



Thread	Sealtite Size (inch)	Min. Internal Bore (mm)	Dimensions in mm					Standard Package	Article Number	Weight (Kg/100)
			A	B	C	D	E			
Pg 16	1/2"	13,9	37	13	30	-	27	10	810.116.9	6,3
Pg 21	3/4"	18,5	40	15	36	-	36	5	810.121.9	8,4
Pg 29	1"	23,8	46	15	46	-	46	5	810.129.9	25,0

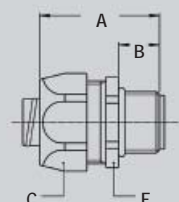

NPT straight fitting, male, stainless steel (AISI-316).



Thread	Sealtite Size (inch)	Min. Internal Bore (mm)	Dimensions in mm					Standard Package	Article Number	Weight (Kg/100)
			A	B	C	D	E			
1/2" NPT	3/8"	10,2	35	12	26	-	24	10	814.112.9	5,6
1/2" NPT	1/2"	13,9	37	13	29	-	27	10	814.116.9	6,2
3/4" NPT	3/4"	18,5	40	15	35	-	33	5	814.120.9	8,9
1" NPT	1"	23,8	46	15	45	-	43	5	814.126.9	25,0



Anaconda stainless steel AISI-316 "food fitting" for Anaconda Sealtite.

These special stainless steel AISI-316 Anaconda fittings can be used with all types of Anaconda Sealtite (except CNP) and offer the highest corrosion resistance. These stainless steel are specifically smooth and give a good protection especially for the pharmaceutical and food industry.

Material & Construction:

Construction: Stainless steel (AISI-316) fitting, consisting of 6 parts (lower seal, counter nut, upper seal, clamping ring, ferrule and body).

Material: Counter nut and body are stainless steel (AISI-316) and the ferrule is from nickel plated brass. Clamping ring and insert are from PA6 (red for ISO metric).



The blue rubber upper and lower seals are made from FDA approved TPE

Special approvals: Special TPE seals, halogen-free, specially formulated for food and beverage applications per FDA guideline CFR 21.

Temperature: -45 °C till +105 °C continuous.

Protection class: IP 68 according EN 60529, IP69K according DIN 40050-9 (till 40 Bar high pressure).

Colour: Metal.

ISO straight food grade fitting, male, stainless steel (AISI-316).

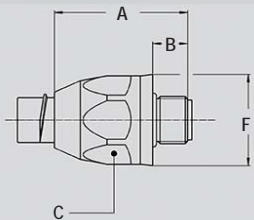
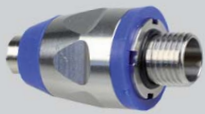

Thread ISO	Sealtite Size (inch)	Min. Internal Bore (mm)	Dimensions in mm					Standard Package	Article Number	Weight (Kg/100)
			A	B	C	D	F			
M16 x 1,5	3/8"	10,4	48	12	27	-	31	10	832.016.9	6,6
M20 x 1,5	1/2"	13,8	50	13	30	-	34	10	832.020.9	8,0
M25 x 1,5	3/4"	18,5	57	15	36	-	41	5	832.025.9	11,8
M32 x 1,5	1"	23,8	68	15	46	-	53	5	832.032.9	22,8
M40 x 1,5	1.1/4"	31,8	75	16	54	-	62	2	832.040.9	34,2
M50 x 1,5	1.1/2"	36,8	81	18	63	-	70	1	832.050.9	38,6
M63 x 1,5	2"	47,8	88	20	77	-	85	1	832.063.9	76,6

**ANACONDA
SEALTITE®
SPECIAL**

**LIQUID-TIGHT
FITTINGS FOR
SEALTITE
IP 68**



Anaconda swivel fittings, stainless steel AISI-316 , for Anaconda Sealtite.

The swivel version stainless steel AISI-316 Anaconda fittings can be used with all types of Anaconda Sealtite (except CNP). This Anaconda fitting is a universal fitting with a special swivel mechanism for a higher tensile strength and a high water proof protection (IP67). All ferrules are turned nickel plated brass versions for a better fit. The high quality stainless steel AISI-316 offers a superb corrosion protection in combination with a nice appearance.



Construction: Stainless steel AISI-316 fitting, consisting of 4 parts (counter nut, clamping ring, ferrule and body).

Material: Counter nut and body are stainless steel AISI-316. Clamping ring is made from PA6 and the ferrule is made from nickel plated brass. The O-rings are from NBR rubber (black for ISO).

Temperature: -45 °C till +105 °C continuous

Protection class: IP 67

Colour: Metal

ANACONDA COMPACT FITTINGS

LIQUID-TIGHT FITTINGS FOR SEALTITE IP 67

NPT 45° swivel fitting, male, stainless steel (AISI-316).

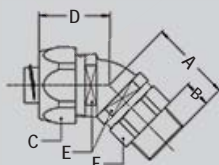

Thread	Sealtite Size (inch)	Min. Internal Bore (mm)	Dimensions in mm						Standard Package	Article Number	Weight (Kg/100)
			A	B	C	D	E	F			
NPT 1/2"	3/8"	10,4	36	12	27	28	22	22	10	819.212.9	11,5
NPT 1/2"	1/2"	13,8	36	12	30	30	27	25	10	819.216.9	14,0
NPT 3/4"	3/4"	17,4	-	12	36	-	-	-	5	838.220.9	22,0
NPT 1"	1"	23,4	-	13	46	-	-	-	5	838.226.9	37,0

NPT 90° swivel fitting, male, stainless steel (AISI-316).

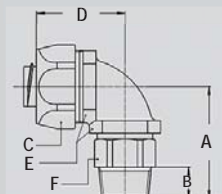

Thread	Sealtite Size (inch)	Min. Internal Bore (mm)	Dimensions in mm						Standard Package	Article Number	Weight (Kg/100)
			A	B	C	D	E	F			
NPT 1/2"	3/8"	10,4	41	12	27	35	22	22	10	819.512.9	12,0
NPT 1/2"	1/2"	13,8	41	12	30	37	27	25	10	819.516.9	14,0
NPT 3/4"	3/4"	17,4	-	12	36	-	-	-	5	838.520.9	23,5
NPT 1"	1"	23,4	-	13	46	-	-	-	5	838.526.9	42,0



Anaconda nickel plated brass elbow fitting, mirror-polished as “food fitting” for Anaconda Sealtite.

These special polished nickel plated brass Anaconda elbow fittings can be used with all types of Anaconda Sealtite (except CNP) and offer a high corrosion resistance. Because of the special mirror-polished treatment these fittings are specifically smooth and give a good protection especially for the pharmaceutical and food industry.



Material & Construction:

Construction: Nickel plated brass fitting, consisting of 4 parts (counter nut, clamping ring, ferrule and body).

Material: Counter nut, body and ferrule are nickel plated brass with exception of size 3/8" till 1" where the ferrule is from galvanised steel. Clamping ring and inserts are made from PA6 red for ISO metric.

Temperature: -45 °C till +105 °C continuous.

Protection class: IP 67 (dust-proof, water-tight).

Colour: Metal.

ISO 90° fitting, male, mirror-polished nickel plated brass.



Thread	Sealtite	Min. Internal Bore (mm)	Dimensions in mm					Standard Package	Article Number	Weight (Kg/100)
			A	B	C	D	F			
M16 x 1,5	5/16"	8,3	32	12	26	42	22	10	818.915.1	8,2
M20 x 1,5	5/16"	8,3	33	13	26	42	22	10	818.914.1	8,4
M16 x 1,5	3/8"	10,2	32	12	26	42	22	10	818.916.1	8,2
M20 x 1,5	3/8"	10,2	33	13	26	42	22	10	818.917.1	8,4
M20 x 1,5	1/2"	13,9	36	13	29	43	27	10	818.920.1	12,6
M25 x 1,5	3/4"	18,5	43	15	35	48	33	5	818.925.1	19,2
M32 x 1,5	1"	23,8	48	15	45	59	42	5	818.932.1	31,6
M40 x 1,5	1.1/4"	31,8	57	16	54	68	51	2	818.940.1	56,1
M50 x 1,5	1.1/2"	36,8	63	18	63	78	60	2	818.950.1	85,3
M63 x 1,5	2"	47,8	74	20	77	96	74	2	818.963.1	139,8

**ANACONDA
SEALTITE®
SPECIAL**

**LIQUID-TIGHT
FITTINGS FOR
SEALTITE
IP 66**



Anamet zinc diecast fitting for Anaconda Sealtite.

The zinc diecast Anamet fittings are especially for the large sizes Anaconda Sealtite (with exception of CNP). This Anamet fitting offers good corrosion protection in combination with a smooth appearance.

Material & Construction:

Construction: Zinc diecast fitting, consisting of 4 parts (counter nut, clamping ring, ferrule and body).

Material: Counter nut and body are zinc diecasted, ferrule is steel plated. Clamping rings are from PA6.

Temperature: -40 °C till +125 °C continuous.

Protection class: IP 67 (dust-proof, water-tight).

Colour: Metal.

ANAMET FITTINGS

LIQUID-TIGHT FITTINGS FOR SEALTITE IP 67

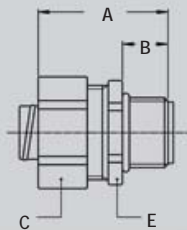

ISO straight fitting, male, zinc diecast

Thread	Sealtite Size (inch)	Min. Internal Bore (mm)	Dimensions in mm					Standard Package	Article Number	Weight (Kg/100)
			A	B	C	D	E			
M50 x 1,5	1.1/2"	37,5	47	15	59	-	57	2	293.040.0	21,6
M63 x 1,5	2"	48,5	55	19	74	-	73	2	293.050.0	34,0

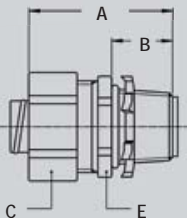

NPT straight fitting, male, zinc diecast

Thread	Sealtite Size (inch)	Min. Internal Bore (mm)	Dimensions in mm					Standard Package	Article Number	Weight (Kg/100)
			A	B	C	D	E			
NPT 2.1/2"	2.1/2"	61,0	71	24	90	-	86	1	294.063.0	67,4
NPT 3"	3"	74,0	75	26	108	-	104	1	294.075.0	96,6
NPT 4"	4"	95,0	80	28	134	-	128	1	294.099.0	125,0

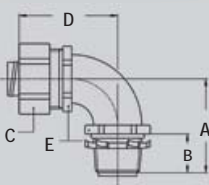

NPT 90° fitting, male, zinc diecast

Thread	Sealtite Size (inch)	Min. Internal Bore (mm)	Dimensions in mm					Standard Package	Article Number	Weight (Kg/100)
			A	B	C	D	E			
NPT 2.1/2"	2.1/2"	61,0	86	24	90	104	86	1	294.963.0	117,8
NPT 3"	3"	74,0	98	26	108	112	104	1	294.975.0	172,8
NPT 4"	4"	95,0	112	28	134	127	128	1	294.999.0	278,6



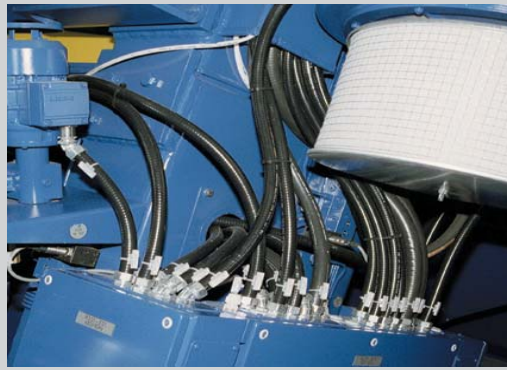
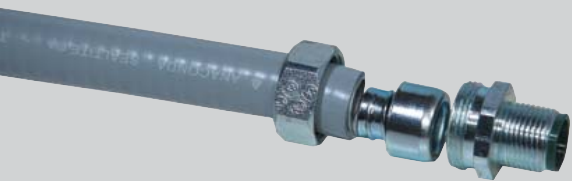

Anamet galvanised steel fittings for Sealite.

The galvanised steel Anamet fittings can be used with all types of Anaconda Sealite (except CNP) and are particularly used where a wider temperature range is required (for instance with type HCX). Because of the UL & CSA approvals the fittings are also suitable for export projects outside Europe.

Material & Construction:

Construction: Galvanised steel fitting, consisting of 3 parts (counter nut, ferrule and body).

Material: Counter nut, ferrule and body are galvanised

steel. Inserts are made from PA6 (green for ISO metric, blue for Pg and white for NPT).

Special approvals: UL-514B (file # E 14814) and CSA C22.2 (file # 65178).

Suitable for use in hazardous environments according NEC:

- Article 501.10 (B) (2) Class I, Division 2
- Article 502.10 (A) (2) and (B) (2) Class II, Division 1 and 2
- Article 503.10 (A) (3) and (B) Class III, Division 1 and 2

Temperature: -55 °C till +300 °C continuous.

Protection class: IP 67 (dust-proof, water-tight).

Colour: Metal.



ISO straight fitting, male, galvanised steel.

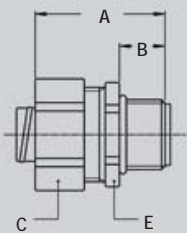

Thread	Sealite	Min. Internal Bore (mm)	Dimensions in mm					Standard Package	Article Number	Weight (Kg/100)
			A	B	C	D	E			
M16 x 1,5	3/8"	9,7	37	15	26	-	24	25	295.012.0	6,4
M20 x 1,5	1/2"	13,7	37	15	29	-	27	25	295.016.0	6,8
M25 x 1,5	3/4"	18,8	38	15	35	-	33	25	295.020.0	10,0
M32 x 1,5	1"	24,2	44	18	42	-	40	10	295.026.0	15,0



ISO 45° fitting, male, galvanised steel.

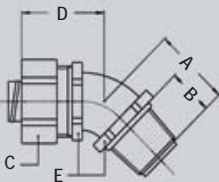

Thread	Sealite	Min. Internal Bore (mm)	Dimensions in mm					Standard Package	Article Number	Weight (Kg/100)
			A	B	C	D	E			
M16 x 1,5	3/8"	9,7	22	15	26	29	27	25	295.412.0	7,8
M20 x 1,5	1/2"	13,7	24	15	29	29	27	25	295.416.0	8,2
M25 x 1,5	3/4"	18,8	27	15	35	32	32	10	295.420.0	16,8
M32 x 1,5	1"	24,2	30	18	42	37	40	5	295.426.0	21,6



ISO 90° fitting, male, galvanised steel.

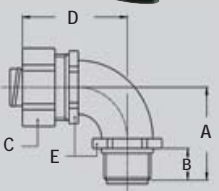

Thread	Sealite	Min. Internal Bore (mm)	Dimensions in mm					Standard Package	Article Number	Weight (Kg/100)
			A	B	C	D	E			
M16 x 1,5	3/8"	9,7	32	15	26	34	27	25	295.912.0	10,0
M20 x 1,5	1/2"	13,7	33	15	29	38	27	25	295.916.0	10,6
M25 x 1,5	3/4"	18,8	37	15	35	44	34	10	295.920.0	21,4
M32 x 1,5	1"	24,2	44	18	42	51	40	5	295.926.0	25,6

ANAMET FITTINGS

LIQUID-TIGHT FITTINGS FOR SEALTITE IP 67



Pg straight fitting, male, galvanised steel.

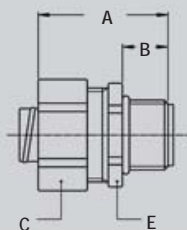

Thread	Sealtite Size (inch)	Min. Internal Bore (mm)	Dimensions in mm					Standard Package	Article Number	Weight (Kg/100)
			A	B	C	D	E			
Pg 11	3/8"	9,7	37	15	26	-	24	25	299.011.0	6,8
Pg 13,5	3/8"	10,4	37	15	26	-	24	25	299.013.0	6,8
Pg 16	1/2"	13,7	38	15	29	-	27	25	299.016.0	7,2
Pg 21	3/4"	18,8	38	15	35	-	33	25	299.020.0	10,8
Pg 29	1"	24,2	44	18	42	-	40	5	299.026.0	15,6
Pg 36	1.1/4"	31,6	54	18	56	-	55	5	299.035.0	38,4
Pg 42	1.1/2"	36,8	62	18	64	-	61	1	299.040.0	56,0
Pg 48	2"	48,0	64	18	77	-	77	1	299.050.0	68,0



Pg 45° fitting, male, galvanised steel.

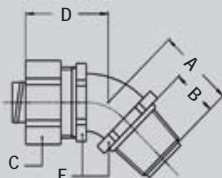

Thread	Sealtite Size (inch)	Min. Internal Bore (mm)	Dimensions in mm					Standard Package	Article Number	Weight (Kg/100)
			A	B	C	D	E			
Pg 11	3/8"	9,7	22	15	26	29	27	25	299.411.0	8,2
Pg 13,5	3/8"	10,4	22	15	26	29	27	25	299.413.0	8,2
Pg 16	1/2"	13,7	24	15	29	29	27	25	299.416.0	8,2
Pg 21	3/4"	18,8	27	15	35	32	32	10	299.420.0	13,6
Pg 29	1"	24,2	33	18	42	37	-	5	299.426.0	22,4
Pg 36	1.1/4"	31,6	38	18	56	46	-	5	299.435.0	46,4
Pg 42	1.1/2"	36,8	44	18	64	55	-	1	299.440.0	63,0
Pg 48	2"	48,0	51	18	77	58	-	1	299.450.0	106,0



Pg 90° fitting, male, galvanised steel.

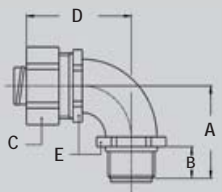

Thread	Sealtite Size (inch)	Min. Internal Bore (mm)	Dimensions in mm					Standard Package	Article Number	Weight (Kg/100)
			A	B	C	D	E			
Pg 11	3/8"	9,7	32	15	26	36	27	25	299.911.0	10,6
Pg 13,5	3/8"	10,4	32	15	26	36	27	25	299.913.0	10,6
Pg 16	1/2"	13,7	33	15	29	38	27	25	299.916.0	11,0
Pg 21	3/4"	18,8	37	15	35	44	34	10	299.920.0	17,8
Pg 29	1"	24,2	44	18	42	51	39	5	299.926.0	28,4
Pg 36	1.1/4"	31,6	44	18	56	61	-	5	299.935.0	52,0
Pg 42	1.1/2"	36,8	62	18	64	81	-	1	299.940.0	72,0
Pg 48	2"	48,0	69	18	77	91	-	1	299.950.0	124,0



NPT straight fitting, male, galvanised steel (Including lock nut).

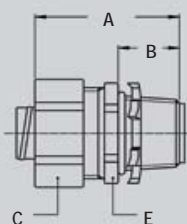

Thread	Sealtite Size (inch)	Min. Internal Bore (mm)	Dimensions in mm					Standard Package	Article Number	Weight (Kg/100)
			A	B	C	D	E			
NPT 1/2"	3/8"	10,4	37	15	26	-	24	25	298.012.0	6,8
NPT 1/2"	1/2"	13,7	37	15	29	-	27	25	298.016.0	7,3
NPT 3/4"	3/4"	18,8	38	15	35	-	33	25	298.020.0	10,6
NPT 1"	1"	24,2	44	18	42	-	40	5	298.026.0	15,6
NPT 1.1/4"	1.1/4"	31,6	54	18	56	-	55	5	298.035.0	18,4
NPT 1.1/2"	1.1/2"	36,8	60	18	64	-	61	1	298.040.0	27,0
NPT 2"	2"	48,0	64	18	77	-	77	1	298.050.0	78,0
NPT 2.1/2"	2.1/2"	58,5	86	27	92	-	-	1	298.063.0	154,0
NPT 3"	3"	72,0	94	30	108	-	-	1	298.075.0	206,0
NPT 4"	4"	95,0	102	32	133	-	-	1	298.099.0	298,0

NPT 45° fitting, male, galvanised steel
(including lock nut).

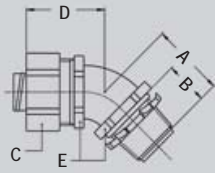

Thread	Sealtite Size (inch)	Min. Internal Bore (mm)	Dimensions in mm					Standard Package	Article Number	Weight (Kg/100)
			A	B	C	D	E			
NPT 1/2"	3/8"	10,4	22	15	26	29	24	25	298.412.0	8,2
NPT 1/2"	1/2"	13,7	24	15	29	29	27	25	298.416.0	8,2
NPT 3/4"	3/4"	18,8	27	15	35	32	32	25	298.420.0	13,6
NPT 1"	1"	24,2	30	18	42	37	-	5	298.426.0	22,4
NPT 1.1/4"	1.1/4"	31,6	38	18	56	46	-	5	298.435.0	46,4
NPT 1.1/2"	1.1/2"	36,8	44	18	64	55	-	1	298.440.0	73,0
NPT 2"	2"	48,0	51	18	77	58	-	1	298.450.0	106,0
NPT 2.1/2"	2.1/2"	58,5	91	27	92	91	-	1	298.463.0	346,0
NPT 3"	3"	72,0	110	30	108	110	-	1	298.475.0	450,0
NPT 4"	4"	95,0	118	32	133	118	-	1	298.499.0	820,0

NPT 90° fitting, male, galvanised steel
(including lock nut).

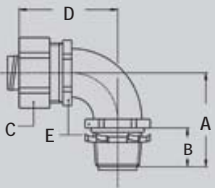

Thread	Sealtite Size (inch)	Min. Internal Bore (mm)	Dimensions in mm					Standard Package	Article Number	Weight (Kg/100)
			A	B	C	D	E			
NPT 1/2"	3/8"	10,4	32	15	26	36	27	25	298.912.0	10,6
NPT 1/2"	1/2"	13,7	32	15	29	36	27	25	298.916.0	11,0
NPT 3/4"	3/4"	18,8	37	15	35	44	34	10	298.920.0	17,2
NPT 1"	1"	24,2	44	18	42	51	40	5	298.926.0	26,4
NPT 1.1/4"	1.1/4"	31,6	46	18	56	58	-	5	298.935.0	52,8
NPT 1.1/2"	1.1/2"	36,8	62	18	64	81	-	1	298.940.0	87,0
NPT 2"	2"	48,0	67	18	77	91	-	1	298.950.0	128,0
NPT 2.1/2"	2.1/2"	58,5	183	27	92	215	-	1	298.963.0	382,0
NPT 3"	3"	72,0	220	30	108	258	-	1	298.975.0	500,0
NPT 4"	4"	95,0	287	32	133	327	-	1	298.999.0	980,0

NPT straight fitting, female, galvanised steel.

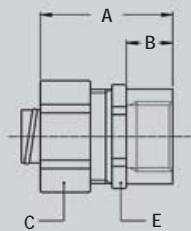

Thread	Sealtite Size (inch)	Min. Internal Bore (mm)	Dimensions in mm					Standard Package	Article Number	Weight (Kg/100)
			A	B	C	D	E			
NPT 1/2"	3/8"	10,4	33	11	26	-	24	25	298.612.0	5,9
NPT 1/2"	1/2"	13,7	34	11	29	-	27	25	298.616.0	6,4
NPT 3/4"	3/4"	18,8	36	12	35	-	33	25	298.620.0	9,6
NPT 1"	1"	24,2	42	15	42	-	40	5	298.626.0	14,0

STN straight boxconnector fitting,
galvanised steel.

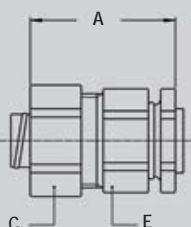

For hole Min. - Max.	Sealtite Size (inch)	Min. Internal Bore (mm)	Dimensions in mm					Standard Package	Article Number	Weight (Kg/100)
			A	B	C	D	E			
22 - 25	3/8"	10,4	37	-	26	-	26	25	298.212.0	8,2
22 - 25	1/2"	13,7	37	-	29	-	27	25	298.216.0	9,1
28 - 31	3/4"	18,8	40	-	35	-	34	25	298.220.0	13,8
34 - 37	1"	23,8	45	-	42	-	40	5	298.226.0	18,8
43 - 47	1.1/4"	31,6	67	-	56	-	57	5	298.235.0	56,8
49 - 53	1.1/2"	36,8	67	-	64	-	68	1	298.240.0	84,0
61 - 66	2"	48,0	59	-	77	-	-	1	298.250.0	128,0

STN 90° boxconnector fitting, galvanised steel.

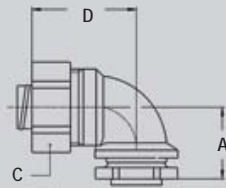

For hole	Sealtite	Min. Internal	Dimensions in mm					Standard	Article	Weight
Min. - Max.	Size (inch)	Bore (mm)	A	B	C	D	E	Package	Number	(Kg/100)
22 - 25	3/8"	10,4	-	-	26	-	-	25	298.812.0	9,6
22 - 25	1/2"	13,7	-	-	29	-	-	25	298.816.0	13,8
28 - 31	3/4"	18,8	-	-	35	-	-	10	298.820.0	16,4
34 - 37	1"	23,8	-	-	42	-	-	5	298.826.0	36,4

Grounding ferrule, galvanised steel.



Thread	Sealtite	Min. Internal	Dimensions in mm					Standard	Article	Weight
	Size (inch)	Bore (mm)	A	B	C	D	E	Package	Number	(Kg/100)
-	3/8"	10,4	-	-	-	-	-	50	297.212.0	1,3
-	1/2"	13,7	-	-	-	-	-	25	297.216.0	1,3
-	3/4"	18,8	-	-	-	-	-	25	297.220.0	1,4
-	1"	24,2	-	-	-	-	-	25	297.226.0	1,8
-	1.1/4"	31,6	-	-	-	-	-	5	297.235.0	2,0
-	1.1/2"	36,8	-	-	-	-	-	5	297.240.0	2,4
-	2"	48,0	-	-	-	-	-	5	297.250.0	2,8
-	2.1/2"	58,5	-	-	-	-	-	5	297.263.0	6,4
-	3"	72,0	-	-	-	-	-	5	297.275.0	7,2
-	4"	95,0	-	-	-	-	-	1	297.299.0	7,6

* From 1.1/4" the ferrule is made in aluminum

Lock nuts, NPT, galvanised steel, with "Tiger Grip".



Thread	Sealtite	Min. Internal	Dimensions in mm					Standard	Article	Weight
NPT	Size (inch)	Bore (mm)	A	B	C	D	E	Package	Number	(Kg/100)
NPT 1/2"	-	-	-	-	-	-	-	100	297.416.0	0,3
NPT 3/4"	-	-	-	-	-	-	-	100	297.420.0	0,3
NPT 1"	-	-	-	-	-	-	-	50	297.426.0	0,3
NPT 1.1/4"	-	-	-	-	-	-	-	50	297.435.0	0,4
NPT 1.1/2"	-	-	-	-	-	-	-	50	297.440.0	0,5
NPT 2"	-	-	-	-	-	-	-	25	297.450.0	0,7
NPT 2.1/2"	-	-	-	-	-	-	-	1	297.463.0	9,4
NPT 3"	-	-	-	-	-	-	-	1	297.475.0	-
NPT 4"	-	-	-	-	-	-	-	1	297.499.0	-

ANAMET
FITTINGS

ACCESSORIES